

**IPCVA** Instituto de Promoción  
de la Carne Vacuna  
Argentina  
**Argentine Beef Promotion Institute**

Esmeralda 130, piso 22 (C1035ABD)  
Ciudad Autónoma de Buenos Aires - Argentina.  
(+54-11) 4328-8152 / info@ipcva.com.ar



[www.argentinebeef.org.ar](http://www.argentinebeef.org.ar)  
[www.carneargentina.org.ar](http://www.carneargentina.org.ar)  
[www.ipcva.com.ar](http://www.ipcva.com.ar)  
[www.ipcva.com.ar/guia.php](http://www.ipcva.com.ar/guia.php)

[/ipcva.argentina](https://www.facebook.com/ipcva.argentina)  
[/carneargentina.argentinebeef](https://www.facebook.com/carneargentina.argentinebeef)  
[@argentinebeef](https://www.instagram.com/argentinebeef)



WeChat

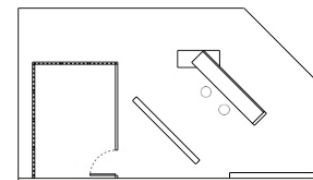
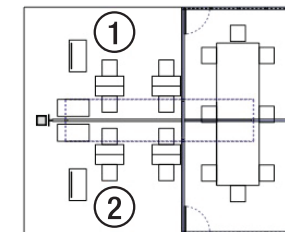
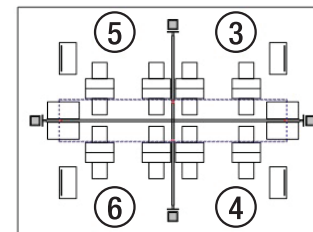
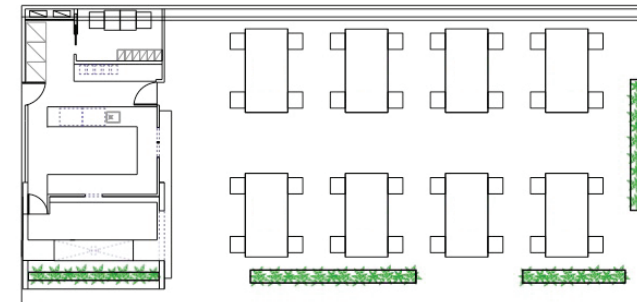

1. AZUL NATURAL BEEF S.A.
2. COMPAÑÍA CENTRAL PAMPEANA S.A.
3. GRUPO LEQUIO
4. INDUSTRIAS FRIGORÍFICAS SUR S.A.
5. MANECA S.A.
6. OFFAL EXP S.A.

Welcome to a land of taste

**ARGENTINE**  **BEEF**

## AZUL NATURAL BEEF S.A.

**ADDRESS:** MAIPÚ 374 - 3º PISO, BUENOS AIRES  
**Postal Code:** 1006  
**Phone:** (5411) 5297 0000 / 4325 9752  
**E-mail:** cdiazdelfino@devesa.com  
**Web Address:** www.devesa.com

### COMMERCIAL CONTACT DATA:

CARLOS DÍAZ DELFINO  
**Job-Function:** Export Manager  
**Phone:** (5411) 5297 0000 / 4325 9752  
**E-mail:** cdiazdelfino@devesa.com

**ANNUAL SLAUGHTER TOTAL CAPACITY:** 185.000 Heads  
**PROCESS CERTIFICATIONS:** BRC, HACCP, Animal Welfare  
**RELIGIOUS CERTIFICATIONS:** Kosher, Halal

**SENASA Number:** 5039

## COMPAÑÍA CENTRAL PAMPEANA S.A.

**ADDRESS:** ENTRE RÍOS 2370, 1 ST FLOOR  
SAN ISIDRO, BUENOS AIRES  
**Postal Code:** B1640GCF  
**Phone:** (5411)5252-9208  
**E-mail:** info@ccpfoods.com.ar  
**Web Address:** www.ccpfoods.com.ar

### COMMERCIAL CONTACT DATA:

MARIA JOSE SOLIS COLOMBO  
**Job-Function:** Supply Chain Director  
**Phone:** (5411) 5252-9208  
**E-mail:** msoliscolombo@ccpfoods.com.ar

### COMPANY'S BRIEF DESCRIPTION:

Azul Natural Beef / Devesa is a family business that has been involved in the meat industry and raising cattle for over a century in Europe and Argentina. We offer the highest quality beef products, in the same natural condition and care with which they have been raised. We offer a wide portfolio of meat products from carcass and primal cuts to value-added raw. The creation of value begins in the fields with the raising of our own cattle and continues in the processing facility with the elaboration of our tailor-made products, guaranteeing an excellent quality and presentation, without hormones or antibiotics. We are responsive to the needs of all our customers, from wholesalers to restaurants and meal-makers, so that everyone can enjoy a product of the highest quality. Our grain or grass fed beef cuts and offals are exported to markets across the globe, such as: Europe, Asia, Middle East, EEUU. Devesa's certified Angus meat is highly demanded due to its natural marbling, tenderness, taste, and juiciness. This is the result of strict animal selection, natural rations and high quality standards.

**ANNUAL SLAUGHTER TOTAL CAPACITY:** 120.000 Heads  
**PROCESS CERTIFICATIONS:** GAP / HACCP / POES/ SPS / SSOP / BRC  
**RELIGIOUS CERTIFICATIONS:** Halal

**SENASA Number:** 2550/391/249

### COMPANY'S BRIEF DESCRIPTION:

Compañía Central Pampeana SA is a leading company in the market with the objective of distributing beef to the world. We are a team of professionals who, thanks to our strategic associates' network, are globally present. In CCP we focus on our global customer. The unmatched quality of Argentinian beef, meeting the highest standards of quality in the processing process allows us to offer a product that satisfies the global consumer needs. In a complex and changing market, we work to adding value for our customers. Our main strength is the capacity to work with the entire production chain, from the farmer to the final consumer.

**ANNUAL SLAUGHTER TOTAL CAPACITY:** 312.000 cattle Heads - 192.000 pork heads  
**PROCESS CERTIFICATIONS:** GMP / HCCP / SSOP / BRC / ANGUS BEEF/ HQB, Animal Welfare  
**RELIGIOUS CERTIFICATIONS:** Halal, Kosher

**SENASA Number:** 2595/ 2555 / 2520

### COMPANY'S BRIEF DESCRIPTION:

Grupo Lequio has a large participation in the refrigeration industry, slaughter and production, both of meat cuts and of processed bovine and pork products for local and external consumption. The group's structure is supported by an excellent work team with more than 1,700 qualified people committed to the activity. The Group's plants have the necessary authorizations to export to the demanding European, American and Asian markets. It markets chilled, vacuum packed and frozen cuts of beef. The production comes from the Treasury or top-quality raw materials. Due to its location in the center of the country, its plants have a competitive advantage that allows targeting the acquisition of quality raw material; being its origin the Humid Pampa.

## INDUSTRIAS FRIGORÍFICAS SUR S.A.

**ADDRESS:** MMIRAMAR Y RÍO NEGRO, LOMA HERMOSA,  
TRES DE FEBRERO, BUENOS AIRES  
**Postal Code:** 1057  
**Phone/Fax:** (5411) 4739-2999  
**E-mail:** contacto@ifssa.com.ar  
**Web Address:** www.ifssa.com.ar

### COMMERCIAL CONTACT DATA:

TOMÁS AGOSTI  
**Job-Function:** Commercial Department  
**Phone:** (5411) 4739-2999  
**E-mail:** tomas@sabusiness.com.ar

**ANNUAL SLAUGHTER TOTAL CAPACITY:** 150.000 Heads  
**PROCESS CERTIFICATIONS:** BPM, HACCP  
**RELIGIOUS CERTIFICATIONS:** Halal

**SENASA Number:** 3574

### COMPANY'S BRIEF DESCRIPTION:

Located in a privileged area close to the major trading centres and cattle market, and only 30 km (18 miles) from Argentina's Downtown -with excellent access via highway-, rises since 1956 this industrial plant property of Industrias Frigoríficas Sur S.A., an unavoidable referent in Argentina's slaughter industry. Most products are intended for domestic consumption; however, in the last years the export area has evolved firmly.

## MANECA S.A.

**ADDRESS:** Av. Hipolito Yrigoyen 1926, San fernando Buenos Aires,  
Argentina  
**Postal Code:** B1646 CGO  
**Phone:** +54 11 4725 1400  
**E-mail:** info@maneca.com  
**Web Address:** www.maneca.com

### COMMERCIAL CONTACT DATA:

MAXIMILIANO CHIESA  
**Job-Function:** Director  
**Phone:** +54 11 4725 1400  
**E-mail:** info@maneca.com

**ANNUAL SLAUGHTER TOTAL CAPACITY:** 100.000 ANIMALS  
**RELIGIOUS CERTIFICATIONS:** Halal

**SENASA Number:** 3648

### COMPANY'S BRIEF DESCRIPTION:

MANECA is a family business with a tradition in the production of the best quality Argentine beef. We are a cycle 2 establishment. We export our cuts to various world markets mainly China. We have Mc Donald's certification

## GRUPO LEQUIO (#2595 #2555 # 2520)

SA Carnes Pampeanas SA, Frigorífico Alberdi SA, Carnes del Interior SA.  
**ADDRESS:** Head Office Alto Buro, Junín 191, Piso 15, Of. 5 a 8  
**Postal Code:** 2000, Rosario, Santa Fe, Argentina  
**Fax:** (54 341) 5282430  
**E-mail:** info@grupolequio.com  
**Web Address:** www.grupolequio.com

### COMMERCIAL CONTACT DATA:

LEONARDO LEQUIO  
**Job-Function:** Director  
**Phone:** (54 341) 4685956  
**E-mail:** leolequio@grupolequio.com

ESTEBAN RODRIGUEZ  
**Job-Function:** Foreign Trade Manager  
**Phone:** (54 343) 6110842  
**E-mail:** estebanrodriguez@grupolequio.com

SANTIAGO ESCALES  
**Job-Function:** International Sales  
**Phone:** (54 343) 509 8517  
**E-mail:** santiagoescales@grupolequio.com

## OFFAL EXP S.A.

**ADDRESS:** GORRITI 196 -FORUM PUERTO NORTE  
EDIFICIO CUBO A, 7º PISO.  
ROSARIO, SANTA FE.  
**Postal Code:** S2013CTR  
**Phone/Fax:** (54341) 4345000  
**E-mail:** commercial@expobureau.com.ar  
**Web Address:** www.offalexp.com.ar

### COMMERCIAL CONTACT DATA:

SERGIO GRASSO  
**Job-Function:** Commercial Director  
**Phone:** (54341) 434-5000  
**E-mail:** sergiograsso@expobureau.com.ar

ROBERTINO GRASSO  
**Job-Function:** Commercial  
**Phone:** (54341) 434-5000  
**E-mail:** robertinograsso@expobureau.com.ar

**PROCESS CERTIFICATIONS:** HACCP  
**RELIGIOUS CERTIFICATIONS:** Halal, Kosher

### COMPANY'S BRIEF DESCRIPTION:

The main exporter of beef offal from South America to the world